



CIVIL GEOTECHNICAL SERVICES
ABN 26 474 013 724
PO Box 678 Croydon Vic 3136
Telephone: 9723 0744 Facsimile: 9723 0799

5th October 2021

Our Reference: 21060:NB913

Winslow Constructors Pty Ltd
50 Barry Road
CAMPBELLFIELD VIC 3061

Dear Sirs/Madams,

**RE: LEVEL 1 EARTHWORKS INSPECTION AND TESTING
NEWBRIDGE – STAGE 4 (WALLAN)**

Please find attached our Report No's 21060R001 to 21060/R024 which relate to the field density testing that was conducted within the filled allotments at the above subdivision. The level 1 inspections and associated field density testing commenced in February 2021 and was completed in March 2021.

The inspections and testing of the earthworks was undertaken in general accordance with the Level 1 requirements of AS 3798 - Guidelines on Earthworks for Commercial and Residential Developments.

The site inspection and testing was performed by experienced geotechnicians from this office. Any areas that were deemed unsatisfactory were reworked and retested under their supervision. The testing was performed to the relevant Australian Standards and the accompanying test reports carry NATA endorsement. The attached compaction results, which were located randomly throughout the fill profile, are considered to be representative of the bulk fill materials that were placed across the reported allotments by Winslow Constructors during the aforementioned period. The approximate locations of the field density tests can be seen on the attached plan (Figure 1).

We are of the view that the bulk fill materials that have been placed across the reported allotments by Winslow Constructors during the aforementioned period can be considered as having been placed in a controlled manner to a minimum density ratio of 95% (standard compactive effort).

Please contact the undersigned if you require any additional information.

Civil Geotechnical Services

A handwritten signature in blue ink, appearing to read 'Nick Brock', is written over a faint circular stamp.

Nick Brock

FIGURE 1

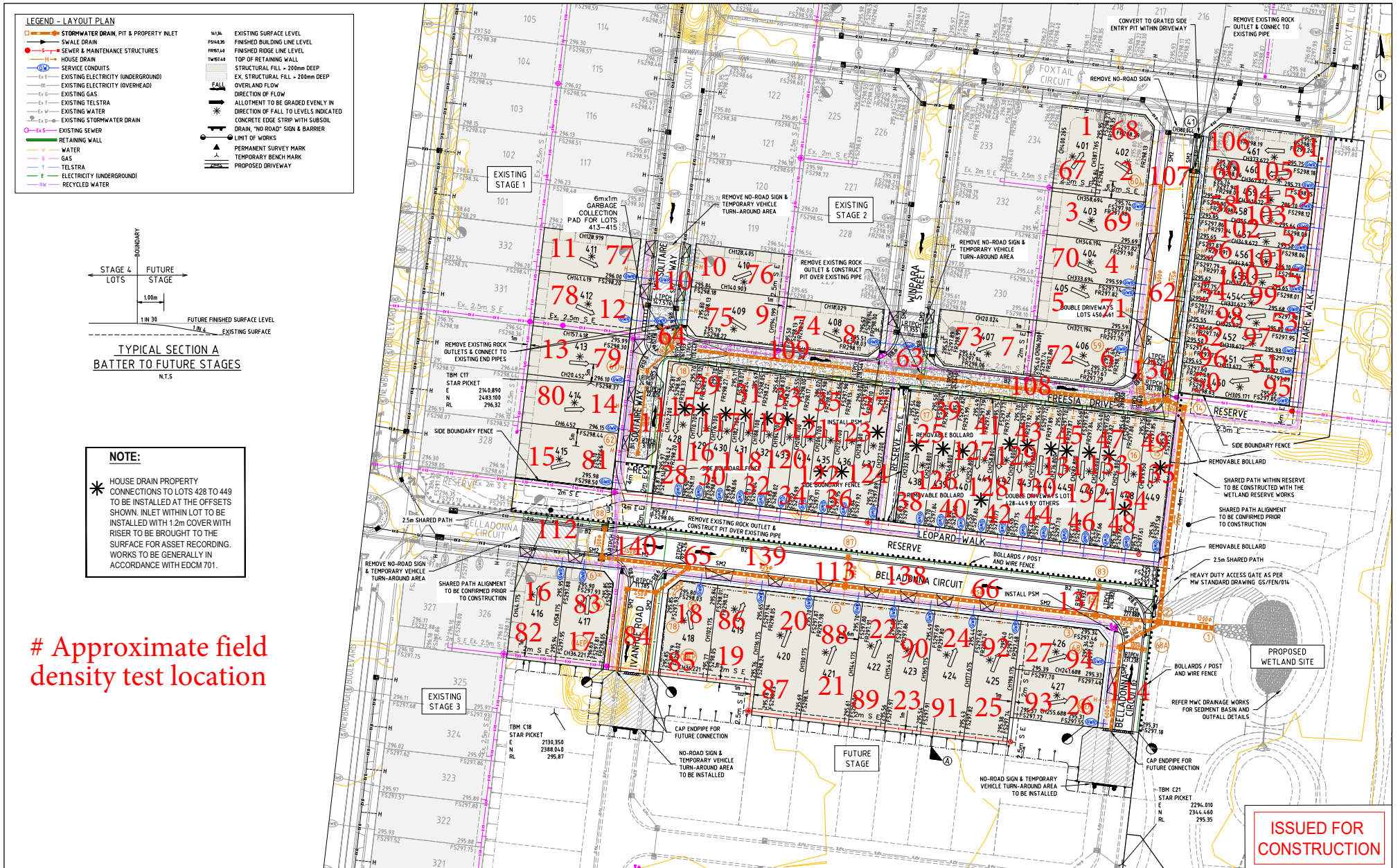

Approximate field density test location

ISSUED FOR CONSTRUCTION

NO.	REVISION	DATE	DESIGN	APPROVED
F	NOTES ADDED	28.01.21	AY	J#
E	EX. PIT 41 NOTATION ADDED	12.08.20	MR	TP
D	REMOVABLE BOLLARD ADDED	19.05.20	TG	TP
C	LANEWAYS UPDATED	10.02.20	MR	TP
B	CONSTRUCTION ISSUE	18.11.19	MR	TP
A	ISSUED TO COUNCIL	30.09.19	MR	TP

RESIMAX GROUP
MITCHELL SHIRE COUNCIL

Approved for Construction

Melway Reference: 655 E4

UrbanDesign and management

Urban Design and Management Pty Ltd
PO Box 468 Sunbury 3429
Phone: +61 3 9971 6300 | Fax: +61 3 9971 6399
Office 1, Level 1, 114 Evans Street, Sunbury, VIC, 3429

Principal: RESIMAX GROUP PTY LTD
2 DREWERY PLACE
MELBOURNE VIC 3000

Project Management | Land Development | Civil Engineering | Traffic and Transport Engineering | Urban Design

Designed: MROSSITTO

Checked: T.PHILLIPS

Approved: T.MILINKOVIC

Date: SEPTEMBER 2019

NEWBRIDGE SOUTH ESTATE
STAGE 4
MITCHELL SHIRE COUNCIL
DETAIL PLAN

Drawing No: 18040-04-02

Revision: E

Sheet No: 02 of 23

Scale @ A1: 0 5 10 20
1:500

© Urban Design and Management Pty Ltd
ABN 62 525 443 156



COMPACTION ASSESSMENT

Job No 21060
 Report No 21060/R001
 Date Issued 15/03/2021

CIVIL GEOTECHNICAL SERVICES

6 - 8 Rose Avenue, Croydon 3136

Client	WINSLOW CONSTRUCTORS PTY LTD (CAMPBELLFIELD)	Tested by	AC
Project	NEWBRIDGE - STAGE 4	Date tested	03/02/21
Location	WALLAN	Checked by	JHF

Feature	EARTHWORKS	Layer thickness	200 mm	Time: 14:07
---------	------------	-----------------	--------	-------------

Test procedure AS 1289.2.1.1 & 5.8.1

Test No	1	2	3	4	5	6
Location	REFER TO FIGURE 1	REFER TO FIGURE 1	REFER TO FIGURE 1	REFER TO FIGURE 1	REFER TO FIGURE 1	REFER TO FIGURE 1
Approximate depth below FSL						
Measurement depth	mm	175	175	175	175	175
Field wet density	t/m ³	2.01	1.89	2.01	1.99	2.11
Field moisture content	%	24.1	23.0	21.5	20.2	15.7

Test procedure AS 1289.5.7.1

Test No	1	2	3	4	5	6
Compactive effort	Standard					
Oversize rock retained on sieve	mm	19.0	19.0	19.0	19.0	19.0
Percent of oversize material	wet	0	0	0	0	0
Peak Converted Wet Density	t/m ³	2.07	1.96	2.10	2.05	2.16
Adjusted Peak Converted Wet Density	t/m ³	-	-	-	-	-
Optimum Moisture Content	%	26.5	25.5	24.0	22.0	18.0

Moisture Variation From Optimum Moisture Content	2.0% dry	2.5% dry	2.0% dry	1.5% dry	2.0% dry	2.0% dry
--	----------	----------	----------	----------	----------	----------

Density Ratio (R _{HD})	%	97.5	96.5	96.0	97.0	97.5	98.5
-----------------------------------	---	------	------	------	------	------	------

Material description

No 1 - 6 Clay Fill

AVRLOT HILF V1.10 MAR 13



The results of the tests, calibrations and/or measurements included in this document are traceable to Australian/national standards. Accredited for compliance with ISO/IEC 17025 - Testing

Accreditation No 9909

Approved Signatory : Justin Fry



COMPACTION ASSESSMENT

Job No 21060
 Report No 21060/R002
 Date Issued 11/03/2021

CIVIL GEOTECHNICAL SERVICES

6 - 8 Rose Avenue, Croydon 3136

Client	WINSLOW CONSTRUCTORS PTY LTD (CAMPBELLFIELD)	Tested by	AC
Project	NEWBRIDGE - STAGE 4	Date tested	04/02/21
Location	WALLAN	Checked by	JHF

Feature	EARTHWORKS	Layer thickness	200 mm	Time: 07:28
---------	------------	-----------------	--------	-------------

Test procedure AS 1289.2.1.1 & 5.8.1

Test No	7	8	9	10	11	12
Location	REFER TO FIGURE 1	REFER TO FIGURE 1	REFER TO FIGURE 1	REFER TO FIGURE 1	REFER TO FIGURE 1	REFER TO FIGURE 1
Approximate depth below FSL						
Measurement depth	mm	175	175	175	175	175
Field wet density	t/m ³	1.84	1.86	1.85	1.81	1.86
Field moisture content	%	29.9	24.3	31.3	32.2	20.1

Test procedure AS 1289.5.7.1

Test No	7	8	9	10	11	12
Compactive effort	Standard					
Oversize rock retained on sieve	mm	19.0	19.0	19.0	19.0	19.0
Percent of oversize material	wet	0	0	0	0	0
Peak Converted Wet Density	t/m ³	1.86	1.90	1.91	1.80	1.90
Adjusted Peak Converted Wet Density	t/m ³	-	-	-	-	-
Optimum Moisture Content	%	28.0	24.5	31.5	32.5	22.5

Moisture Variation From Optimum Moisture Content	2.0% wet	0.5% dry	0.0%	0.5% dry	2.0% dry	2.5% dry
--	----------	----------	------	----------	----------	----------

Density Ratio (R _{HD})	%	99.5	98.0	97.0	100.5	97.5	95.5
-----------------------------------	---	------	------	------	-------	------	------

Material description

No 7 - 12 Clay Fill

AVRLOT HILF V1.10 MAR 13



The results of the tests, calibrations and/or measurements included in this document are traceable to Australian/national standards. Accredited for compliance with ISO/IEC 17025 - Testing

Accreditation No 9909

Approved Signatory : Justin Fry



COMPACTION ASSESSMENT

Job No 21060
 Report No 21060/R003
 Date Issued 15/03/2021

CIVIL GEOTECHNICAL SERVICES

6 - 8 Rose Avenue, Croydon 3136

Client	WINSLOW CONSTRUCTORS PTY LTD (CAMPBELLFIELD)	Tested by	AC
Project	NEWBRIDGE - STAGE 4	Date tested	05/02/21
Location	WALLAN	Checked by	JHF

Feature	EARTHWORKS	Layer thickness	200 mm	Time: 07:16
---------	------------	-----------------	--------	-------------

Test procedure AS 1289.2.1.1 & 5.8.1

Test No	13	14	15	16	17	18
Location	REFER TO FIGURE 1	REFER TO FIGURE 1	REFER TO FIGURE 1	REFER TO FIGURE 1	REFER TO FIGURE 1	REFER TO FIGURE 1
Approximate depth below FSL						
Measurement depth	mm	175	175	175	175	175
Field wet density	t/m ³	2.01	1.89	2.01	2.05	2.04
Field moisture content	%	24.4	22.2	23.9	23.8	24.8

Test procedure AS 1289.5.7.1

Test No	13	14	15	16	17	18
Compactive effort	Standard					
Oversize rock retained on sieve	mm	19.0	19.0	19.0	19.0	19.0
Percent of oversize material	wet	0	0	0	0	0
Peak Converted Wet Density	t/m ³	2.05	1.93	2.10	2.10	2.06
Adjusted Peak Converted Wet Density	t/m ³	-	-	-	-	-
Optimum Moisture Content	%	26.5	24.5	26.0	26.5	26.0

Moisture Variation From Optimum Moisture Content	2.0% dry	2.5% dry	2.0% dry	2.5% dry	1.0% dry	1.5% dry
--	----------	----------	----------	----------	----------	----------

Density Ratio (R _{HD})	%	98.0	97.5	95.5	97.5	98.5	100.0
-----------------------------------	---	------	------	------	------	------	-------

Material description

No 13 - 18 Clay Fill

AVRLOT HILF V1.10 MAR 13



The results of the tests, calibrations and/or measurements included in this document are traceable to Australian/national standards. Accredited for compliance with ISO/IEC 17025 - Testing

Accreditation No 9909

Approved Signatory : Justin Fry



COMPACTION ASSESSMENT

Job No 21060
 Report No 21060/R004
 Date Issued 27/02/2021

CIVIL GEOTECHNICAL SERVICES

6 - 8 Rose Avenue, Croydon 3136

Client	WINSLOW CONSTRUCTORS PTY LTD (CAMPBELLFIELD)	Tested by	AC
Project	NEWBRIDGE - STAGE 4	Date tested	08/02/21
Location	WALLAN	Checked by	JHF

Feature	EARTHWORKS	Layer thickness	200 mm	Time: 10:08
---------	------------	-----------------	--------	-------------

Test procedure AS 1289.2.1.1 & 5.8.1

Test No	19	20	21	22	23	24
Location	REFER TO FIGURE 1	REFER TO FIGURE 1	REFER TO FIGURE 1	REFER TO FIGURE 1	REFER TO FIGURE 1	REFER TO FIGURE 1
Approximate depth below FSL						
Measurement depth	mm	175	175	175	175	175
Field wet density	t/m ³	1.95	1.94	1.91	1.95	1.97
Field moisture content	%	23.4	20.6	19.6	19.1	16.3

Test procedure AS 1289.5.7.1

Test No	19	20	21	22	23	24
Compactive effort	Standard					
Oversize rock retained on sieve	mm	19.0	19.0	19.0	19.0	19.0
Percent of oversize material	wet	0	0	0	0	0
Peak Converted Wet Density	t/m ³	1.95	2.01	2.00	1.95	1.96
Adjusted Peak Converted Wet Density	t/m ³	-	-	-	-	-
Optimum Moisture Content	%	25.0	18.5	20.5	21.0	18.5

Moisture Variation From Optimum Moisture Content	1.5% dry	2.0% wet	1.0% dry	2.0% dry	2.5% dry	2.0% dry
--	----------	----------	----------	----------	----------	----------

Density Ratio (R _{HD})	%	100.0	97.0	95.5	100.0	100.5	100.5
-----------------------------------	---	-------	------	------	-------	-------	-------

Material description

No 19 - 24 Clay Fill

AVRLOT HILF V1.10 MAR 13



The results of the tests, calibrations and/or measurements included in this document are traceable to Australian/national standards. Accredited for compliance with ISO/IEC 17025 - Testing

Accreditation No 9909

Approved Signatory : Justin Fry



COMPACTION ASSESSMENT

Job No 21060
 Report No 21060/R005
 Date Issued 17/03/2021

CIVIL GEOTECHNICAL SERVICES

6 - 8 Rose Avenue, Croydon 3136

Client	WINSLOW CONSTRUCTORS PTY LTD (CAMPBELLFIELD)	Tested by	AC
Project	NEWBRIDGE - STAGE 4	Date tested	09/02/21
Location	WALLAN	Checked by	JHF

Feature	EARTHWORKS	Layer thickness	200 mm	Time: 15:28
---------	------------	-----------------	--------	-------------

Test procedure AS 1289.2.1.1 & 5.8.1

Test No	25	26	27	28	29	30
Location	REFER TO FIGURE 1	REFER TO FIGURE 1	REFER TO FIGURE 1	REFER TO FIGURE 1	REFER TO FIGURE 1	REFER TO FIGURE 1
Approximate depth below FSL						
Measurement depth	mm	175	175	175	175	175
Field wet density	t/m ³	2.09	2.10	2.11	2.01	2.04
Field moisture content	%	22.0	21.0	25.8	24.0	21.0

Test procedure AS 1289.5.7.1

Test No	25	26	27	28	29	30
Compactive effort	Standard					
Oversize rock retained on sieve	mm	19.0	19.0	19.0	19.0	19.0
Percent of oversize material	wet	0	0	0	0	0
Peak Converted Wet Density	t/m ³	2.10	2.20	2.15	2.05	2.10
Adjusted Peak Converted Wet Density	t/m ³	-	-	-	-	-
Optimum Moisture Content	%	24.5	23.5	28.0	24.0	23.0

Moisture Variation From Optimum Moisture Content	2.5% dry	2.5% dry	2.0% dry	0.0%	2.0% dry	2.5% dry
--	----------	----------	----------	------	----------	----------

Density Ratio (R _{HD})	%	99.5	95.5	98.0	98.0	97.5	96.5
-----------------------------------	---	------	------	------	------	------	------

Material description

No 25 - 30 Clay Fill

AVRLOT HILF V1.10 MAR 13



The results of the tests, calibrations and/or measurements included in this document are traceable to Australian/national standards. Accredited for compliance with ISO/IEC 17025 - Testing

Accreditation No 9909

Approved Signatory : Justin Fry



COMPACTION ASSESSMENT

Job No 21060
 Report No 21060/R006
 Date Issued 17/03/2021

CIVIL GEOTECHNICAL SERVICES

6 - 8 Rose Avenue, Croydon 3136

Client	WINSLOW CONSTRUCTORS PTY LTD (CAMPBELLFIELD)	Tested by	AC
Project	NEWBRIDGE - STAGE 4	Date tested	10/02/21
Location	WALLAN	Checked by	JHF

Feature	EARTHWORKS	Layer thickness	200 mm	Time:	14:30
---------	------------	-----------------	--------	-------	-------

Test procedure AS 1289.2.1.1 & 5.8.1

Test No	31	32	33	34	35	36
Location	REFER TO FIGURE 1	REFER TO FIGURE 1	REFER TO FIGURE 1	REFER TO FIGURE 1	REFER TO FIGURE 1	REFER TO FIGURE 1
Approximate depth below FSL						
Measurement depth	mm	175	175	175	175	175
Field wet density	t/m ³	2.01	2.01	1.99	1.93	1.98
Field moisture content	%	21.5	27.0	23.3	21.2	20.9

Test procedure AS 1289.5.7.1

Test No	31	32	33	34	35	36
Compactive effort	Standard					
Oversize rock retained on sieve	mm	19.0	19.0	19.0	19.0	19.0
Percent of oversize material	wet	0	0	0	0	0
Peak Converted Wet Density	t/m ³	2.10	2.01	2.00	1.95	2.03
Adjusted Peak Converted Wet Density	t/m ³	-	-	-	-	-
Optimum Moisture Content	%	23.5	28.5	26.0	23.5	23.0

Moisture Variation From Optimum Moisture Content	2.0% dry	1.5% dry	2.5% dry	2.5% dry	2.0% dry	2.5% dry
--	----------	----------	----------	----------	----------	----------

Density Ratio (R _{HD})	%	96.0	100.5	99.5	99.0	98.0	97.5
-----------------------------------	---	------	-------	------	------	------	------

Material description

No 31 - 36 Clay Fill

AVRLOT HILF V1.10 MAR 13



The results of the tests, calibrations and/or measurements included in this document are traceable to Australian/national standards. Accredited for compliance with ISO/IEC 17025 - Testing

Accreditation No 9909

Approved Signatory : Justin Fry



COMPACTION ASSESSMENT

Job No 21060
 Report No 21060/R007
 Date Issued 16/03/2021

CIVIL GEOTECHNICAL SERVICES

6 - 8 Rose Avenue, Croydon 3136

Client	WINSLOW CONSTRUCTORS PTY LTD (CAMPBELLFIELD)	Tested by	AC
Project	NEWBRIDGE - STAGE 4	Date tested	11/02/21
Location	WALLAN	Checked by	JHF

Feature	EARTHWORKS	Layer thickness	200 mm	Time: 14:59
---------	------------	-----------------	--------	-------------

Test procedure AS 1289.2.1.1 & 5.8.1

Test No	37	38	39	40	41	42
Location	REFER TO FIGURE 1	REFER TO FIGURE 1	REFER TO FIGURE 1	REFER TO FIGURE 1	REFER TO FIGURE 1	REFER TO FIGURE 1
Approximate depth below FSL						
Measurement depth	mm	175	175	175	175	175
Field wet density	t/m ³	1.96	1.89	1.96	1.91	2.11
Field moisture content	%	21.4	21.1	20.9	22.7	21.2

Test procedure AS 1289.5.7.1

Test No	37	38	39	40	41	42
Compactive effort	Standard					
Oversize rock retained on sieve	mm	19.0	19.0	19.0	19.0	19.0
Percent of oversize material	wet	0	0	0	0	0
Peak Converted Wet Density	t/m ³	1.97	1.95	2.00	1.92	2.20
Adjusted Peak Converted Wet Density	t/m ³	-	-	-	-	-
Optimum Moisture Content	%	24.0	23.5	23.5	25.5	23.5

Moisture Variation From Optimum Moisture Content	2.5% dry	2.0% dry	2.5% dry	2.5% dry	2.0% dry	2.5% dry
--	----------	----------	----------	----------	----------	----------

Density Ratio (R _{HD})	%	99.5	97.0	98.0	99.5	96.0	98.5
-----------------------------------	---	------	------	------	------	------	------

Material description

No 37 - 42 Clay Fill

AVRLOT HILF V1.10 MAR 13



The results of the tests, calibrations and/or measurements included in this document are traceable to Australian/national standards. Accredited for compliance with ISO/IEC 17025 - Testing

Accreditation No 9909

Approved Signatory : Justin Fry



COMPACTION ASSESSMENT

CIVIL GEOTECHNICAL SERVICES

6 - 8 Rose Avenue, Croydon 3136

Job No 21060
Report No 21060/R008
Date Issued 15/03/2021

Client	WINSLOW CONSTRUCTORS PTY LTD (CAMPBELLFIELD)	Tested by	AC
Project	NEWBRIDGE - STAGE 4	Date tested	12/02/21
Location	WALLAN	Checked by	JHF

Feature	EARTHWORKS	Layer thickness	200 mm	Time: 14:57
---------	------------	-----------------	--------	-------------

Test procedure AS 1289.2.1.1 & 5.8.1

Test No	43	44	45	46	47	48
Location	REFER TO FIGURE 1	REFER TO FIGURE 1	REFER TO FIGURE 1	REFER TO FIGURE 1	REFER TO FIGURE 1	REFER TO FIGURE 1
Approximate depth below FSL						
Measurement depth	mm	175	175	175	175	175
Field wet density	t/m ³	1.96	1.97	1.95	2.00	1.99
Field moisture content	%	26.4	26.0	29.9	30.8	26.9

Test procedure AS 1289.5.7.1

Test No	43	44	45	46	47	48
Compactive effort	Standard					
Oversize rock retained on sieve	mm	19.0	19.0	19.0	19.0	19.0
Percent of oversize material	wet	0	0	0	0	0
Peak Converted Wet Density	t/m ³	2.00	2.02	2.00	2.00	2.06
Adjusted Peak Converted Wet Density	t/m ³	-	-	-	-	-
Optimum Moisture Content	%	28.5	27.5	31.5	33.5	29.5

Moisture Variation From Optimum Moisture Content	2.0% dry	1.5% dry	1.5% dry	2.5% dry	2.5% dry	2.5% dry
--	----------	----------	----------	----------	----------	----------

Density Ratio (R _{HD})	%	97.5	97.5	97.0	100.0	96.5	97.0
-----------------------------------	---	------	------	------	-------	------	------

Material description

No 43 - 48 Clay Fill

AVRLOT HILF V1.10 MAR 13



The results of the tests, calibrations and/or measurements included in this document are traceable to Australian/national standards. Accredited for compliance with ISO/IEC 17025 - Testing

Accreditation No 9909

Approved Signatory : Justin Fry



COMPACTION ASSESSMENT

Job No 21060
 Report No 21060/R009
 Date Issued 17/03/2021

CIVIL GEOTECHNICAL SERVICES

6 - 8 Rose Avenue, Croydon 3136

Client	WINSLOW CONSTRUCTORS PTY LTD (CAMPBELLFIELD)	Tested by	AC
Project	NEWBRIDGE - STAGE 4	Date tested	15/02/21
Location	WALLAN	Checked by	JHF

Feature	EARTHWORKS	Layer thickness	200 mm	Time: 07:27
---------	------------	-----------------	--------	-------------

Test procedure AS 1289.2.1.1 & 5.8.1

Test No	49	50	51	52	53	54
Location	REFER TO FIGURE 1	REFER TO FIGURE 1	REFER TO FIGURE 1	REFER TO FIGURE 1	REFER TO FIGURE 1	REFER TO FIGURE 1
Approximate depth below FSL						
Measurement depth	mm	175	175	175	175	175
Field wet density	t/m ³	2.06	2.04	2.06	2.04	1.99
Field moisture content	%	23.8	24.7	25.0	25.3	23.1

Test procedure AS 1289.5.7.1

Test No	49	50	51	52	53	54
Compactive effort	Standard					
Oversize rock retained on sieve	mm	19.0	19.0	19.0	19.0	19.0
Percent of oversize material	wet	0	0	0	0	0
Peak Converted Wet Density	t/m ³	2.07	2.10	2.04	2.12	2.05
Adjusted Peak Converted Wet Density	t/m ³	-	-	-	-	-
Optimum Moisture Content	%	26.5	27.0	27.5	27.5	25.5

Moisture Variation From Optimum Moisture Content	2.5% dry	2.5% dry	2.5% dry	2.0% dry	2.0% dry	2.5% dry
--	----------	----------	----------	----------	----------	----------

Density Ratio (R _{HD})	%	99.5	97.5	100.5	96.5	97.0	97.0
-----------------------------------	---	------	------	-------	------	------	------

Material description

No 49 - 54 Clay Fill

AVRLOT HILF V1.10 MAR 13



The results of the tests, calibrations and/or measurements included in this document are traceable to Australian/national standards. Accredited for compliance with ISO/IEC 17025 - Testing

Accreditation No 9909

Approved Signatory : Justin Fry



COMPACTION ASSESSMENT

Job No 21060
 Report No 21060/R010
 Date Issued 17/03/2021

CIVIL GEOTECHNICAL SERVICES

6 - 8 Rose Avenue, Croydon 3136

Client	WINSLOW CONSTRUCTORS PTY LTD (CAMPBELLFIELD)	Tested by	AC
Project	NEWBRIDGE - STAGE 4	Date tested	18/02/21
Location	WALLAN	Checked by	JHF

Feature	EARTHWORKS	Layer thickness	200 mm	Time: 07:28
---------	------------	-----------------	--------	-------------

Test procedure AS 1289.2.1.1 & 5.8.1

Test No	55	56	57	58	59	60	
Location	REFER TO FIGURE 1	REFER TO FIGURE 1	REFER TO FIGURE 1	REFER TO FIGURE 1	REFER TO FIGURE 1	REFER TO FIGURE 1	
Approximate depth below FSL							
Measurement depth	mm	175	175	175	175	175	
Field wet density	t/m ³	2.02	2.05	2.07	1.99	1.98	2.04
Field moisture content	%	18.5	17.5	16.7	18.7	16.4	19.0

Test procedure AS 1289.5.7.1

Test No	55	56	57	58	59	60	
Compactive effort	Standard						
Oversize rock retained on sieve	mm	19.0	19.0	19.0	19.0	19.0	
Percent of oversize material	wet	0	0	0	0	0	
Peak Converted Wet Density	t/m ³	2.08	2.10	2.08	2.09	2.05	2.05
Adjusted Peak Converted Wet Density	t/m ³	-	-	-	-	-	-
Optimum Moisture Content	%	20.5	19.5	17.5	20.5	19.0	21.0

Moisture Variation From Optimum Moisture Content	2.0% dry	2.0% dry	1.0% dry	2.0% dry	2.5% dry	2.0% dry
--	----------	----------	----------	----------	----------	----------

Density Ratio (R _{HD})	%	97.0	97.5	99.5	95.5	96.5	99.5
-----------------------------------	---	------	------	------	------	------	------

Material description

No 55 - 60 Clay Fill

AVRLOT HILF V1.10 MAR 13



The results of the tests, calibrations and/or measurements included in this document are traceable to Australian/national standards. Accredited for compliance with ISO/IEC 17025 - Testing

Accreditation No 9909

Approved Signatory : Justin Fry



COMPACTION ASSESSMENT

Job No 21060
 Report No 21060/R011
 Date Issued 17/03/2021

CIVIL GEOTECHNICAL SERVICES

6 - 8 Rose Avenue, Croydon 3136

Client	WINSLOW CONSTRUCTORS PTY LTD (CAMPBELLFIELD)	Tested by	AC
Project	NEWBRIDGE - STAGE 4	Date tested	19/02/21
Location	WALLAN	Checked by	JHF

Feature	EARTHWORKS	Layer thickness	200 mm	Time: 07:36
---------	------------	-----------------	--------	-------------

Test procedure AS 1289.2.1.1 & 5.8.1

Test No	61	62	63	64	65	66
Location	REFER TO FIGURE 1	REFER TO FIGURE 1	REFER TO FIGURE 1	REFER TO FIGURE 1	REFER TO FIGURE 1	REFER TO FIGURE 1
Approximate depth below FSL						
Measurement depth	mm	175	175	175	175	175
Field wet density	t/m ³	1.98	1.96	1.87	2.09	2.02
Field moisture content	%	18.5	16.7	16.9	18.9	15.7

Test procedure AS 1289.5.7.1

Test No	61	62	63	64	65	66
Compactive effort	Standard					
Oversize rock retained on sieve	mm	19.0	19.0	19.0	19.0	19.0
Percent of oversize material	wet	0	0	0	0	0
Peak Converted Wet Density	t/m ³	2.05	2.00	1.91	2.10	2.04
Adjusted Peak Converted Wet Density	t/m ³	-	-	-	-	-
Optimum Moisture Content	%	21.0	19.0	19.0	21.0	18.0

Moisture Variation From Optimum Moisture Content	2.5% dry	2.5% dry	2.0% dry	2.0% dry	2.5% dry	2.5% dry
--	----------	----------	----------	----------	----------	----------

Density Ratio (R _{HD})	%	96.5	98.0	98.0	99.5	99.0	99.0
-----------------------------------	---	------	------	------	------	------	------

Material description

No 61 - 66 Clay Fill

AVRLOT HILF V1.10 MAR 13



The results of the tests, calibrations and/or measurements included in this document are traceable to Australian/national standards. Accredited for compliance with ISO/IEC 17025 - Testing

Accreditation No 9909

Approved Signatory : Justin Fry



COMPACTION ASSESSMENT

CIVIL GEOTECHNICAL SERVICES

6 - 8 Rose Avenue, Croydon 3136

Job No 21060
Report No 21060/R012
Date Issued 17/03/2021

Client	WINSLOW CONSTRUCTORS PTY LTD (CAMPBELLFIELD)	Tested by	AC
Project	NEWBRIDGE - STAGE 4	Date tested	22/02/21
Location	WALLAN	Checked by	JHF

Feature	EARTHWORKS	Layer thickness	200 mm	Time: 07:34
---------	------------	-----------------	--------	-------------

Test procedure AS 1289.2.1.1 & 5.8.1

Test No	67	68	69	70	71	72
Location	REFER TO FIGURE 1	REFER TO FIGURE 1	REFER TO FIGURE 1	REFER TO FIGURE 1	REFER TO FIGURE 1	REFER TO FIGURE 1
Approximate depth below FSL						
Measurement depth	mm	175	175	175	175	175
Field wet density	t/m ³	2.03	2.06	2.05	2.09	2.12
Field moisture content	%	25.8	24.2	25.8	20.8	25.4

Test procedure AS 1289.5.7.1

Test No	67	68	69	70	71	72
Compactive effort	Standard					
Oversize rock retained on sieve	mm	19.0	19.0	19.0	19.0	19.0
Percent of oversize material	wet	0	0	0	0	0
Peak Converted Wet Density	t/m ³	2.06	2.10	2.12	2.10	2.20
Adjusted Peak Converted Wet Density	t/m ³	-	-	-	-	-
Optimum Moisture Content	%	28.0	26.5	28.5	23.0	28.0

Moisture Variation From Optimum Moisture Content	2.0% dry	2.5% dry	2.5% dry	2.0% dry	2.5% dry	2.5% dry
--	----------	----------	----------	----------	----------	----------

Density Ratio (R _{HD})	%	98.5	98.0	96.5	99.5	96.5	97.0
-----------------------------------	---	------	------	------	------	------	------

Material description

No 67 - 72 Clay Fill

AVRLOT HILF V1.10 MAR 13



The results of the tests, calibrations and/or measurements included in this document are traceable to Australian/national standards. Accredited for compliance with ISO/IEC 17025 - Testing

Accreditation No 9909

Approved Signatory : Justin Fry



COMPACTION ASSESSMENT

Job No 21060
 Report No 21060/R013
 Date Issued 19/03/2021

CIVIL GEOTECHNICAL SERVICES

6 - 8 Rose Avenue, Croydon 3136

Client	WINSLOW CONSTRUCTORS PTY LTD (CAMPBELLFIELD)	Tested by	AC
Project	NEWBRIDGE - STAGE 4	Date tested	23/02/21
Location	WALLAN	Checked by	JHF

Feature	EARTHWORKS	Layer thickness	200 mm	Time: 14:57
---------	------------	-----------------	--------	-------------

Test procedure AS 1289.2.1.1 & 5.8.1

Test No	73	74	75	76	77	78
Location	REFER TO FIGURE 1	REFER TO FIGURE 1	REFER TO FIGURE 1	REFER TO FIGURE 1	REFER TO FIGURE 1	REFER TO FIGURE 1
Approximate depth below FSL						
Measurement depth	mm	175	175	175	175	175
Field wet density	t/m ³	1.91	1.88	1.79	1.78	1.78
Field moisture content	%	21.9	22.9	19.6	20.5	21.1

Test procedure AS 1289.5.7.1

Test No	73	74	75	76	77	78
Compactive effort	Standard					
Oversize rock retained on sieve	mm	19.0	19.0	19.0	19.0	19.0
Percent of oversize material	wet	0	0	0	0	0
Peak Converted Wet Density	t/m ³	1.91	1.90	1.79	1.79	1.86
Adjusted Peak Converted Wet Density	t/m ³	-	-	-	-	-
Optimum Moisture Content	%	24.0	25.0	21.0	23.0	23.0

Moisture Variation From Optimum Moisture Content	2.0% dry	2.0% dry	2.5% dry	2.5% dry	2.0% dry	2.0% dry
--	----------	----------	----------	----------	----------	----------

Density Ratio (R _{HD})	%	100.0	99.0	100.0	99.5	96.0	99.5
-----------------------------------	---	-------	------	-------	------	------	------

Material description

No 73 - 78 Clay Fill

AVRLOT HILF V1.10 MAR 13



The results of the tests, calibrations and/or measurements included in this document are traceable to Australian/national standards. Accredited for compliance with ISO/IEC 17025 - Testing

Accreditation No 9909

Approved Signatory : Justin Fry



COMPACTION ASSESSMENT

Job No 21060
 Report No 21060/R014
 Date Issued 11/03/2021

CIVIL GEOTECHNICAL SERVICES

6 - 8 Rose Avenue, Croydon 3136

Client	WINSLOW CONSTRUCTORS PTY LTD (CAMPBELLFIELD)	Tested by	AC
Project	NEWBRIDGE - STAGE 4	Date tested	24/02/21
Location	WALLAN	Checked by	JHF

Feature	EARTHWORKS	Layer thickness	200 mm	Time: 07:35
---------	------------	-----------------	--------	-------------

Test procedure AS 1289.2.1.1 & 5.8.1

Test No	79	80	81	82	83	84
Location	REFER TO FIGURE 1	REFER TO FIGURE 1	REFER TO FIGURE 1	REFER TO FIGURE 1	REFER TO FIGURE 1	REFER TO FIGURE 1
Approximate depth below FSL						
Measurement depth	mm	175	175	175	175	175
Field wet density	t/m ³	1.93	1.88	1.91	1.96	1.95
Field moisture content	%	26.9	25.0	27.5	25.3	25.9

Test procedure AS 1289.5.7.1

Test No	79	80	81	82	83	84
Compactive effort	Standard					
Oversize rock retained on sieve	mm	19.0	19.0	19.0	19.0	19.0
Percent of oversize material	wet	0	0	0	0	0
Peak Converted Wet Density	t/m ³	2.01	1.91	2.01	2.01	2.05
Adjusted Peak Converted Wet Density	t/m ³	-	-	-	-	-
Optimum Moisture Content	%	24.5	25.0	25.0	25.5	26.0

Moisture Variation From Optimum Moisture Content	2.5% wet	0.0%	2.0% wet	0.0%	0.0%	2.5% wet
--	----------	------	----------	------	------	----------

Density Ratio (R _{HD})	%	96.5	98.5	95.5	97.5	95.0	98.0
-----------------------------------	---	------	------	------	------	------	------

Material description

No 79 - 84 Clay Fill

AVRLOT HILF V1.10 MAR 13



The results of the tests, calibrations and/or measurements included in this document are traceable to Australian/national standards. Accredited for compliance with ISO/IEC 17025 - Testing

Accreditation No 9909

Approved Signatory : Justin Fry



COMPACTION ASSESSMENT

Job No 21060
 Report No 21060/R015
 Date Issued 25/06/2021

CIVIL GEOTECHNICAL SERVICES

6 - 8 Rose Avenue, Croydon 3136

Client	WINSLOW CONSTRUCTORS PTY LTD (CAMPBELLFIELD)	Tested by	AM
Project	NEWBRIDGE - STAGE 4	Date tested	25/02/21
Location	WALLAN	Checked by	JHF

Feature	EARTHWORKS	Layer thickness	200 mm	Time:	08:01
---------	------------	-----------------	--------	-------	-------

Test procedure AS 1289.2.1.1 & 5.8.1

Test No	85	86	87	88	89	90	
Location	REFER TO FIGURE 1	REFER TO FIGURE 1	REFER TO FIGURE 1	REFER TO FIGURE 1	REFER TO FIGURE 1	REFER TO FIGURE 1	
Approximate depth below FSL							
Measurement depth	mm	175	175	175	175	175	
Field wet density	t/m ³	2.06	2.04	2.04	2.05	2.01	2.02
Field moisture content	%	25.7	23.5	23.6	26.9	30.6	25.3

Test procedure AS 1289.5.7.1

Test No	85	86	87	88	89	90	
Compactive effort	Standard						
Oversize rock retained on sieve	mm	19.0	19.0	19.0	19.0	19.0	
Percent of oversize material	wet	0	0	0	0	0	
Peak Converted Wet Density	t/m ³	2.10	2.07	2.08	2.07	2.09	2.06
Adjusted Peak Converted Wet Density	t/m ³	-	-	-	-	-	-
Optimum Moisture Content	%	27.5	25.5	25.5	30.0	21.5	26.0

Moisture Variation From Optimum Moisture Content	1.5% dry	2.0% dry	1.5% dry	2.5% dry	2.5% wet	0.5% dry
--	----------	----------	----------	----------	----------	----------

Density Ratio (R _{HD})	%	98.0	98.5	98.0	99.0	96.0	98.0
-----------------------------------	---	------	------	------	------	------	------

Material description

No 85 - 90 Clay Fill

AVRLOT HILF V1.10 MAR 13



NATA Accredited Laboratory No 9909
 Accredited for compliance with
 ISO/IEC 17025 - Testing

Approved Signatory : Justin Fry



COMPACTION ASSESSMENT

Job No 21060
 Report No 21060/R016
 Date Issued 22/09/2021

CIVIL GEOTECHNICAL SERVICES

6 - 8 Rose Avenue, Croydon 3136

Client	WINSLOW CONSTRUCTORS PTY LTD (CAMPBELLFIELD)	Tested by	AM
Project	NEWBRIDGE - STAGE 4	Date tested	26/02/21
Location	WALLAN	Checked by	JHF

Feature	EARTHWORKS	Layer thickness	200 mm	Time: 07:44
---------	------------	-----------------	--------	-------------

Test procedure AS 1289.2.1.1 & 5.8.1

Test No	91	92	93	94	95	96
Location	REFER TO FIGURE 1	REFER TO FIGURE 1	REFER TO FIGURE 1	REFER TO FIGURE 1	REFER TO FIGURE 1	REFER TO FIGURE 1
Approximate depth below FSL						
Measurement depth	mm	175	175	175	175	175
Field wet density	t/m ³	2.01	1.94	1.97	2.01	1.99
Field moisture content	%	21.8	24.1	24.4	23.8	20.7

Test procedure AS 1289.5.7.1

Test No	91	92	93	94	95	96
Compactive effort	Standard					
Oversize rock retained on sieve	mm	19.0	19.0	19.0	19.0	19.0
Percent of oversize material	wet	0	0	0	0	0
Peak Converted Wet Density	t/m ³	2.07	2.02	2.01	2.07	1.97
Adjusted Peak Converted Wet Density	t/m ³	-	-	-	-	-
Optimum Moisture Content	%	20.0	23.5	25.0	23.0	21.5

Moisture Variation From Optimum Moisture Content	1.5% wet	0.5% wet	0.5% dry	0.5% wet	2.0% wet	1.0% dry
--	----------	----------	----------	----------	----------	----------

Density Ratio (R _{HD})	%	97.0	96.0	98.0	97.0	98.5	98.5
-----------------------------------	---	------	------	------	------	------	------

Material description

No 91 - 96 Clay Fill

AVRLOT HILF V1.10 MAR 13



NATA Accredited Laboratory No 9909
 Accredited for compliance with
 ISO/IEC 17025 - Testing

Approved Signatory : Justin Fry



COMPACTION ASSESSMENT

Job No 21060
 Report No 21060/R017
 Date Issued 25/06/2021

CIVIL GEOTECHNICAL SERVICES

6 - 8 Rose Avenue, Croydon 3136

Client	WINSLOW CONSTRUCTORS PTY LTD (CAMPBELLFIELD)	Tested by	AM
Project	NEWBRIDGE - STAGE 4	Date tested	01/03/21
Location	WALLAN	Checked by	JHF

Feature	EARTHWORKS	Layer thickness	200 mm	Time: 16:19
---------	------------	-----------------	--------	-------------

Test procedure AS 1289.2.1.1 & 5.8.1

Test No	97	98	99	100	101	102
Location	REFER TO FIGURE 1	REFER TO FIGURE 1	REFER TO FIGURE 1	REFER TO FIGURE 1	REFER TO FIGURE 1	REFER TO FIGURE 1
Approximate depth below FSL						
Measurement depth	mm	175	175	175	175	175
Field wet density	t/m ³	2.07	2.00	1.96	1.95	1.93
Field moisture content	%	22.3	26.0	22.3	24.4	20.4

Test procedure AS 1289.5.7.1

Test No	97	98	99	100	101	102
Compactive effort	Standard					
Oversize rock retained on sieve	mm	19.0	19.0	19.0	19.0	19.0
Percent of oversize material	wet	0	0	0	0	0
Peak Converted Wet Density	t/m ³	2.10	2.02	2.01	2.00	1.96
Adjusted Peak Converted Wet Density	t/m ³	-	-	-	-	-
Optimum Moisture Content	%	24.5	28.5	24.5	26.5	23.0

Moisture Variation From Optimum Moisture Content	2.0% dry	2.0% dry	2.5% dry	2.0% dry	2.5% dry	2.0% dry
--	----------	----------	----------	----------	----------	----------

Density Ratio (R _{HD})	%	99.0	99.0	97.5	97.0	99.0	96.5
-----------------------------------	---	------	------	------	------	------	------

Material description

No 97 - 102 Clay Fill

AVRLOT HILF V1.10 MAR 13



NATA Accredited Laboratory No 9909
 Accredited for compliance with
 ISO/IEC 17025 - Testing

Approved Signatory : Justin Fry



COMPACTION ASSESSMENT

Job No 21060
 Report No 21060/R018
 Date Issued 25/06/2021

CIVIL GEOTECHNICAL SERVICES

6 - 8 Rose Avenue, Croydon 3136

Client	WINSLOW CONSTRUCTORS PTY LTD (CAMPBELLFIELD)	Tested by	AM
Project	NEWBRIDGE - STAGE 4	Date tested	02/03/21
Location	WALLAN	Checked by	JHF

Feature	EARTHWORKS	Layer thickness	200 mm	Time: 14:45
---------	------------	-----------------	--------	-------------

Test procedure AS 1289.2.1.1 & 5.8.1

Test No	103	104	105	106	107	108	
Location	REFER TO FIGURE 1	REFER TO FIGURE 1	REFER TO FIGURE 1	REFER TO FIGURE 1	REFER TO FIGURE 1	REFER TO FIGURE 1	
Approximate depth below FSL							
Measurement depth	mm	175	175	175	175	175	
Field wet density	t/m ³	1.95	1.93	1.95	1.97	2.02	2.01
Field moisture content	%	26.1	32.2	29.2	27.7	27.2	25.7

Test procedure AS 1289.5.7.1

Test No	103	104	105	106	107	108	
Compactive effort	Standard						
Oversize rock retained on sieve	mm	19.0	19.0	19.0	19.0	19.0	
Percent of oversize material	wet	0	0	0	0	0	
Peak Converted Wet Density	t/m ³	1.96	1.97	1.97	1.95	2.05	2.03
Adjusted Peak Converted Wet Density	t/m ³	-	-	-	-	-	-
Optimum Moisture Content	%	28.0	35.0	32.0	30.5	30.0	28.5

Moisture Variation From Optimum Moisture Content	2.0% dry	2.5% dry	2.5% dry	2.5% dry	2.5% dry	2.5% dry
--	----------	----------	----------	----------	----------	----------

Density Ratio (R _{HD})	%	99.5	98.0	99.0	101.0	99.0	99.0
-----------------------------------	---	------	------	------	-------	------	------

Material description

No 103 - 108 Clay Fill

AVRLOT HILF V1.10 MAR 13



NATA Accredited Laboratory No 9909
 Accredited for compliance with
 ISO/IEC 17025 - Testing

Approved Signatory : Justin Fry



COMPACTION ASSESSMENT

CIVIL GEOTECHNICAL SERVICES

6 - 8 Rose Avenue, Croydon 3136

Job No 21060
Report No 21060/R019
Date Issued 17/03/2021

Client	WINSLOW CONSTRUCTORS PTY LTD (CAMPBELLFIELD)	Tested by	AC
Project	NEWBRIDGE - STAGE 4	Date tested	03/03/21
Location	WALLAN	Checked by	JHF

Feature	EARTHWORKS	Layer thickness	200 mm	Time: 07:42
---------	------------	-----------------	--------	-------------

Test procedure AS 1289.2.1.1 & 5.8.1

Test No	109	110	111	112	113	114
Location	REFER TO FIGURE1	REFER TO FIGURE1	REFER TO FIGURE1	REFER TO FIGURE1	REFER TO FIGURE1	REFER TO FIGURE1
Approximate depth below FSL						
Measurement depth	mm	175	175	175	175	175
Field wet density	t/m ³	2.09	2.07	2.03	2.04	2.06
Field moisture content	%	18.4	19.8	21.0	25.7	24.2

Test procedure AS 1289.5.7.1

Test No	109	110	111	112	113	114
Compactive effort	Standard					
Oversize rock retained on sieve	mm	19.0	19.0	19.0	19.0	19.0
Percent of oversize material	wet	0	0	0	0	0
Peak Converted Wet Density	t/m ³	2.10	2.06	2.02	2.04	2.05
Adjusted Peak Converted Wet Density	t/m ³	-	-	-	-	-
Optimum Moisture Content	%	21.0	22.0	23.5	28.0	26.0

Moisture Variation From Optimum Moisture Content	2.5% dry	2.0% dry	2.5% dry	2.5% dry	2.0% dry	2.0% dry
--	----------	----------	----------	----------	----------	----------

Density Ratio (R _{HD})	%	99.5	100.0	100.5	100.0	100.5	99.5
-----------------------------------	---	------	-------	-------	-------	-------	------

Material description

No 109 - 114 Clay Fill

AVRLOT HILF V1.10 MAR 13



The results of the tests, calibrations and/or measurements included in this document are traceable to Australian/national standards. Accredited for compliance with ISO/IEC 17025 - Testing

Accreditation No 9909

Approved Signatory : Justin Fry



COMPACTION ASSESSMENT

Job No 21060
 Report No 21060/R020
 Date Issued 17/03/2021

CIVIL GEOTECHNICAL SERVICES

6 - 8 Rose Avenue, Croydon 3136

Client	WINSLOW CONSTRUCTORS PTY LTD (CAMPBELLFIELD)	Tested by	AC
Project	NEWBRIDGE - STAGE 4	Date tested	03/03/21
Location	WALLAN	Checked by	JHF

Feature	EARTHWORKS	Layer thickness	200 mm	Time: 09:02
---------	------------	-----------------	--------	-------------

Test procedure AS 1289.2.1.1 & 5.8.1

Test No	115	116	117	118	119	120
Location	REFER TO FIGURE 1	REFER TO FIGURE 1	REFER TO FIGURE 1	REFER TO FIGURE 1	REFER TO FIGURE 1	REFER TO FIGURE 1
Approximate depth below FSL						
Measurement depth	mm	175	175	175	175	175
Field wet density	t/m ³	2.02	2.05	2.04	1.99	2.03
Field moisture content	%	16.9	24.9	19.7	20.4	17.8

Test procedure AS 1289.5.7.1

Test No	115	116	117	118	119	120
Compactive effort	Standard					
Oversize rock retained on sieve	mm	19.0	19.0	19.0	19.0	19.0
Percent of oversize material	wet	0	0	0	0	0
Peak Converted Wet Density	t/m ³	2.10	2.10	2.05	2.10	2.10
Adjusted Peak Converted Wet Density	t/m ³	-	-	-	-	-
Optimum Moisture Content	%	19.0	27.0	21.5	23.0	20.5

Moisture Variation From Optimum Moisture Content	2.0% dry	2.0% dry	2.0% dry	2.5% dry	2.5% dry	2.0% dry
--	----------	----------	----------	----------	----------	----------

Density Ratio (R _{HD})	%	96.0	97.5	99.5	95.0	96.5	96.5
-----------------------------------	---	------	------	------	------	------	------

Material description

No 115 - 120 Clay Fill

AVRLOT HILF V1.10 MAR 13



The results of the tests, calibrations and/or measurements included in this document are traceable to Australian/national standards. Accredited for compliance with ISO/IEC 17025 - Testing

Accreditation No 9909

Approved Signatory : Justin Fry



COMPACTION ASSESSMENT

Job No 21060
 Report No 21060/R021
 Date Issued 17/03/2021

CIVIL GEOTECHNICAL SERVICES

6 - 8 Rose Avenue, Croydon 3136

Client	WINSLOW CONSTRUCTORS PTY LTD (CAMPBELLFIELD)	Tested by	AC
Project	NEWBRIDGE - STAGE 4	Date tested	04/03/21
Location	WALLAN	Checked by	JHF

Feature	EARTHWORKS	Layer thickness	200 mm	Time: 07:38
---------	------------	-----------------	--------	-------------

Test procedure AS 1289.2.1.1 & 5.8.1

Test No	121	122	123	124	125	126
Location	REFER TO FIGURE 1	REFER TO FIGURE 1	REFER TO FIGURE 1	REFER TO FIGURE 1	REFER TO FIGURE 1	REFER TO FIGURE 1
Approximate depth below FSL						
Measurement depth	mm	175	175	175	175	175
Field wet density	t/m ³	1.93	1.91	1.88	1.95	1.86
Field moisture content	%	22.6	29.0	21.6	20.2	19.9

Test procedure AS 1289.5.7.1

Test No	121	122	123	124	125	126
Compactive effort	Standard					
Oversize rock retained on sieve	mm	19.0	19.0	19.0	19.0	19.0
Percent of oversize material	wet	0	0	0	0	0
Peak Converted Wet Density	t/m ³	2.00	1.96	1.91	2.00	1.90
Adjusted Peak Converted Wet Density	t/m ³	-	-	-	-	-
Optimum Moisture Content	%	25.5	29.0	24.0	22.5	22.5

Moisture Variation From Optimum Moisture Content	2.5% dry	0.0%	2.5% dry	2.5% dry	2.5% dry	2.5% dry
--	----------	------	----------	----------	----------	----------

Density Ratio (R _{HD})	%	96.0	98.0	99.0	97.5	97.5	99.5
-----------------------------------	---	------	------	------	------	------	------

Material description

No 121 - 126 Clay Fill

AVRLOT HILF V1.10 MAR 13



The results of the tests, calibrations and/or measurements included in this document are traceable to Australian/national standards. Accredited for compliance with ISO/IEC 17025 - Testing

Accreditation No 9909

Approved Signatory : Justin Fry



COMPACTION ASSESSMENT

Job No 21060
 Report No 21060/R022
 Date Issued 11/05/2021

CIVIL GEOTECHNICAL SERVICES

6 - 8 Rose Avenue, Croydon 3136

Client	WINSLOW CONSTRUCTORS PTY LTD (CAMPBELLFIELD)	Tested by	AC
Project	NEWBRIDGE - STAGE 4	Date tested	10/03/21
Location	WALLAN	Checked by	JHF

Feature	EARTHWORKS	Layer thickness	200 mm	Time: 07:25
---------	------------	-----------------	--------	-------------

Test procedure AS 1289.2.1.1 & 5.8.1

Test No	127	128	129	130	131	132
Location	REFER TO FIGURE 1	REFER TO FIGURE 1	REFER TO FIGURE 1	REFER TO FIGURE 1	REFER TO FIGURE 1	REFER TO FIGURE 1
Approximate depth below FSL						
Measurement depth	mm	175	175	175	175	175
Field wet density	t/m ³	2.05	2.06	2.16	2.14	2.07
Field moisture content	%	22.6	21.9	24.2	22.7	22.9

Test procedure AS 1289.5.7.1

Test No	127	128	129	130	131	132
Compactive effort	Standard					
Oversize rock retained on sieve	mm	19.0	19.0	19.0	19.0	19.0
Percent of oversize material	wet	0	0	0	0	0
Peak Converted Wet Density	t/m ³	2.09	2.10	2.19	2.16	2.10
Adjusted Peak Converted Wet Density	t/m ³	-	-	-	-	-
Optimum Moisture Content	%	24.5	23.0	24.5	22.0	22.5

Moisture Variation From Optimum Moisture Content	2.0% dry	1.0% dry	0.5% dry	1.0% wet	0.0%	0.5% wet
--	----------	----------	----------	----------	------	----------

Density Ratio (R _{HD})	%	98.5	98.0	99.0	98.5	99.0	99.5
-----------------------------------	---	------	------	------	------	------	------

Material description

No 127 - 132 Clay Fill

AVRLOT HILF V1.10 MAR 13



NATA Accredited Laboratory No 9909
 Accredited for compliance with
 ISO/IEC 17025 - Testing

Approved Signatory : Justin Fry



COMPACTION ASSESSMENT

Job No 21060
 Report No 21060/R023
 Date Issued 22/09/2021

CIVIL GEOTECHNICAL SERVICES

6 - 8 Rose Avenue, Croydon 3136

Client	WINSLOW CONSTRUCTORS PTY LTD (CAMPBELLFIELD)	Tested by	AC
Project	NEWBRIDGE - STAGE 4	Date tested	15/03/21
Location	WALLAN	Checked by	JHF

Feature	EARTHWORKS	Layer thickness	200 mm	Time: 07:28
---------	------------	-----------------	--------	-------------

Test procedure AS 1289.2.1.1 & 5.8.1

Test No	133	134	135	136	137	138
Location	REFER TO FIGURE 1	REFER TO FIGURE 1	REFER TO FIGURE 1	REFER TO FIGURE 1	REFER TO FIGURE 1	REFER TO FIGURE 1
Approximate depth below FSL						
Measurement depth	mm	175	175	175	175	175
Field wet density	t/m ³	2.06	2.08	2.00	1.99	2.00
Field moisture content	%	20.1	21.2	22.4	23.7	23.3

Test procedure AS 1289.5.7.1

Test No	133	134	135	136	137	138
Compactive effort	Standard					
Oversize rock retained on sieve	mm	19.0	19.0	19.0	19.0	19.0
Percent of oversize material	wet	0	0	0	0	0
Peak Converted Wet Density	t/m ³	2.09	2.10	2.03	2.03	2.04
Adjusted Peak Converted Wet Density	t/m ³	-	-	-	-	-
Optimum Moisture Content	%	20.5	21.5	23.0	24.0	25.0

Moisture Variation From Optimum Moisture Content	0.5% dry	0.5% dry	0.5% dry	0.0%	1.5% dry	1.0% dry
--	----------	----------	----------	------	----------	----------

Density Ratio (R _{HD})	%	99.0	99.0	98.0	98.0	98.5	98.0
-----------------------------------	---	------	------	------	------	------	------

Material description

No 133 - 138 Clay Fill

AVRLOT HILF V1.10 MAR 13



NATA Accredited Laboratory No 9909
 Accredited for compliance with
 ISO/IEC 17025 - Testing

Approved Signatory : Justin Fry



COMPACTION ASSESSMENT

Job No 21060
 Report No 21060/R024
 Date Issued 22/09/2021

CIVIL GEOTECHNICAL SERVICES

6 - 8 Rose Avenue, Croydon 3136

Client	WINSLOW CONSTRUCTORS PTY LTD (CAMPBELLFIELD)	Tested by	AC
Project	NEWBRIDGE - STAGE 4	Date tested	16/03/21
Location	WALLAN	Checked by	JHF

Feature	EARTHWORKS	Layer thickness	200 mm	Time: 14:57
---------	------------	-----------------	--------	-------------

Test procedure AS 1289.2.1.1 & 5.8.1

Test No	139	140	-	-	-	-
Location	REFER TO FIGURE 1	REFER TO FIGURE 1				
Approximate depth below FSL						
Measurement depth	mm	175	175	-	-	-
Field wet density	t/m ³	1.93	1.93	-	-	-
Field moisture content	%	20.2	19.4	-	-	-

Test procedure AS 1289.5.7.1

Test No	139	140	-	-	-	-
Compactive effort	Standard					
Oversize rock retained on sieve	mm	19.0	19.0	-	-	-
Percent of oversize material	wet	0	0	-	-	-
Peak Converted Wet Density	t/m ³	1.91	1.90	-	-	-
Adjusted Peak Converted Wet Density	t/m ³	-	-	-	-	-
Optimum Moisture Content	%	22.5	20.0	-	-	-

Moisture Variation From Optimum Moisture Content	2.0% dry	0.5% dry	-	-	-	-
--	----------	----------	---	---	---	---

Density Ratio (R _{HD})	%	101.0	101.5	-	-	-
-----------------------------------	---	-------	-------	---	---	---

Material description

No 139 - 140 Clay Fill

AVRLOT HILF V1.10 MAR 13



NATA Accredited Laboratory No 9909
 Accredited for compliance with
 ISO/IEC 17025 - Testing

Approved Signatory : Justin Fry